

# Dimplex

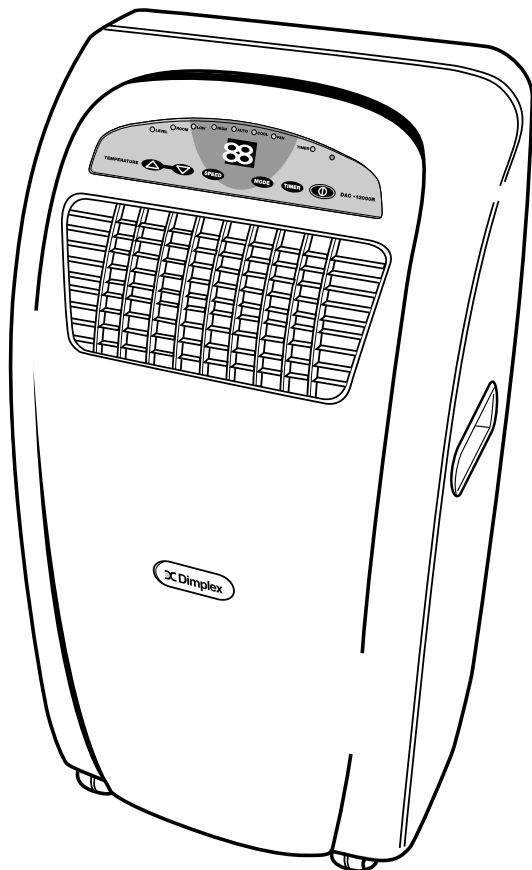

**Air Conditioner – DAC 12000R**

---

---

# CONTENTS.

---

	<b>Page</b>
Introduction . . . . .	2
Features . . . . .	2
Specification . . . . .	3
Important Safeguards . . . . .	4
Energy Saving Tips . . . . .	4
Parts . . . . .	5
Accessories . . . . .	6
Installation . . . . .	6
Operation . . . . .	8
Drainage . . . . .	10
Maintenance . . . . .	11
Trouble Shooting Guide . . . . .	12
Warranty . . . . .	13

---

---

## Introduction.

---

Thank you for choosing a Dimplex air conditioner. This manual contains information, regulations and warnings which are of fundamental importance if the appliance is to be installed correctly and the highest performance, in the safest possible conditions is to be obtained. We suggest that you read the manual carefully before installing or starting up the appliance.

The new Dimplex appliances represent the most highly developed air conditioning units available today.

---

---

## Features

---

The air-conditioning unit is of the mono tube type, transferable (on Wheels) with air/air operating system for domestic use and has 3 settings.

- Ventilate/Fan.
- Cool.
- Dehumidify.

The ventilation mode "moves" the air allowing for its recycling.

The cooling mode, a refrigerating circuit (compressor), cools the room by transferring the heat from inside to outside through the air exhaust hose. While cooling, the air-conditioning unit also dehumidifies the room air.

Humidity absorbed from the air condenses and turns into water that is collected in the internal tank. The water level in the tank is automatically controlled by a float and micro switch and when the preset level is exceeded the compressor indicator will blink and the compressor will shut off automatically, the fan will stay on circulating the air. At this time, you must empty the water tank as described in "Drainage" page 9.

## **Please Note!**

During very humid conditions it will be necessary to empty the water tank more frequently.

An added feature of this model, when enough water is collected in the tank, water is automatically pumped up and through the condenser. The recycled water cools the condenser which increases the cooling capacity output also evaporating some of the water alleviating the frequency of having to empty the water tank.

Dehumidification, in the cooling mode your air-conditioner does remove moisture from the air however another feature of this machine it can be set up to operate as a Dehumidifier with better moisture removal performance.

---

---

## **Specifications.**

---

Cooling Capacity	12000TU/hr 3024cal/hr 3516 watts
Power consumption	850 Watts
Air Volume (max setting)	455m <sup>3</sup> /h
Humidity removal capacity	24L/day
Net weight	36 kg
Power supply	230-240V/50Hz
Compressor	Rotary
Refrigerant	R22
Fan Speed	2
Timer	1-12 hours
Thermostat	16-30
Dimension(WxDxH)	377x400x750 mm
Test Conditions	Temperature 27°C Humidity 60%

---

---

---

## **Important Safeguards.**

---

- The air conditioning unit must always be stored and transported upright. Otherwise you may cause irreparable damage to the compressor; in case of doubt we suggest you wait for at least 24 hours before you start the air-conditioner.
- Avoid restarting the air conditioning unit unless 4 minutes have passed since it was turned off or the compressor may suffer damage.
- Never use the mains plug as a switch to start and turn off the air conditioning unit. Use the provided ON/OFF button located on the control panel.
- Always place the portable air conditioner on a stable surface.
- Connect the portable air conditioner to a correct wall socket.
- Mount the exhaust hose on the portable air conditioner.
- The air conditioning unit should only be used by adults: do not allow children to play with it.

---

---

## **Energy Saving Tips.**

---

- Do not cover or restrict the airflow from the Outlet or Inlet grills. Minimal distance from furniture and wall is 50cm.
- Keep blinds and /or draperies, on any windows, closed during the sunniest part of the day.
- Keep the filter clean. Under normal conditions, the filters should be cleaned approximately every 30 days. Since the filters remove airborne particles, more frequent cleaning maybe necessary, depending on the indoor air quality.

- Please read the instructions carefully and save them in a safe place for future reference.

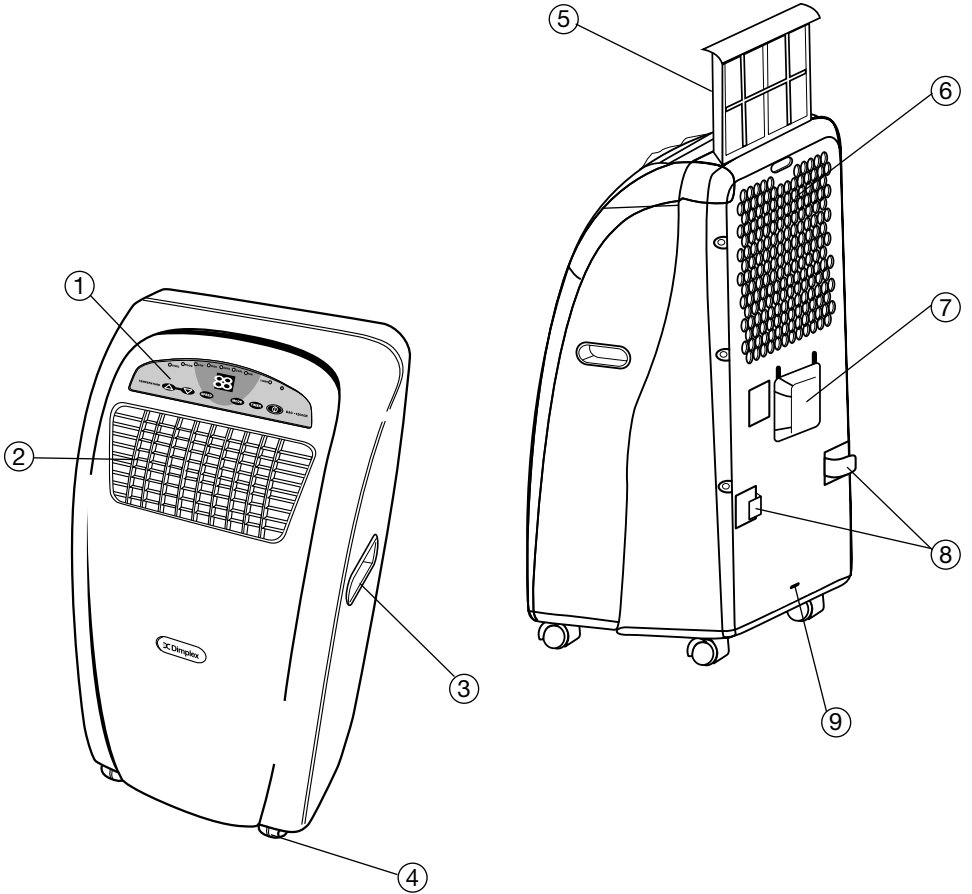

---

---

## Know your Air Conditioner.

---

- |                       |                                       |
|-----------------------|---------------------------------------|
| 1. Control panel      | 6. Air inlet                          |
| 2. Cooling air outlet | 7. Exhaust air outlet                 |
| 3. Handle             | 8. Cord storage                       |
| 4. Castor             | 9. Water stopper (rubber plug inside) |
| 5. Air filter         |                                       |

---

---

## Accessories.

---

1. Adaptor - for insertion over hose and into back of the air conditioner.
2. Adaptor - for insertion over hose and into foam strip.
3. Exhaust hose.
4. Foam strip - for filling the open window space and with hole for connection to exhaust hose.
5. Foam strip - for filling the open window space.
6. Round window connector.
7. Cap for round window connector.
8. Water tray.
9. Remote control.

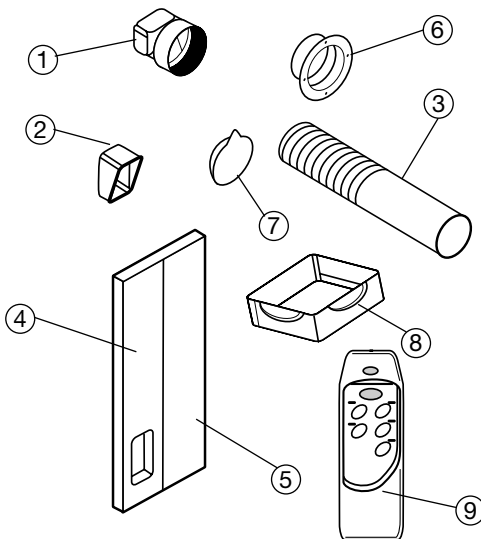

---

---

## Installation.



---

### Mounting of the unit

This unit is a PORTABLE AIR CONDITIONER. It can be moved from room to room, so the cooling can follow you anywhere. The mounting is easy, beneath a window or wall. Please refer to either of the following ways -

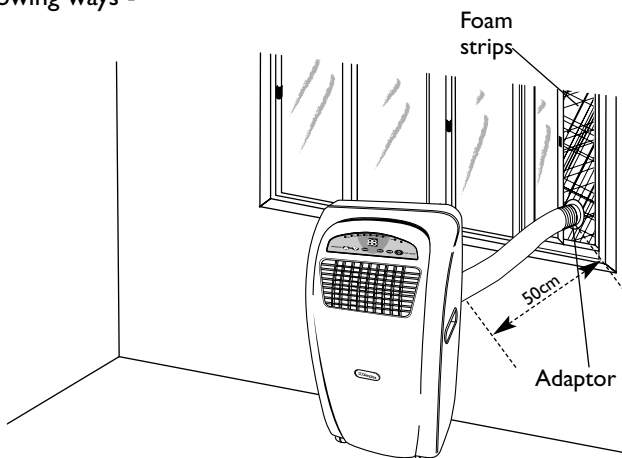
1. Using the foam strips
  - Connect the supplied foam strips with the exhaust pipe, let the hot air flow to the outside.
  - Should the foam strip(s) be too large, cut off the extra part to fit the window.



2. Using the round window connectors.
  - Make a hole (diameter > 112mm) in the wall/glass to fit the supplied round window connector.
  - Take off the adaptor  (the one which does not connect with the unit), fit the hose directly to the round window connector.
  - When the hole is not in use. Use the cap  for the round window connector to cover the hole.

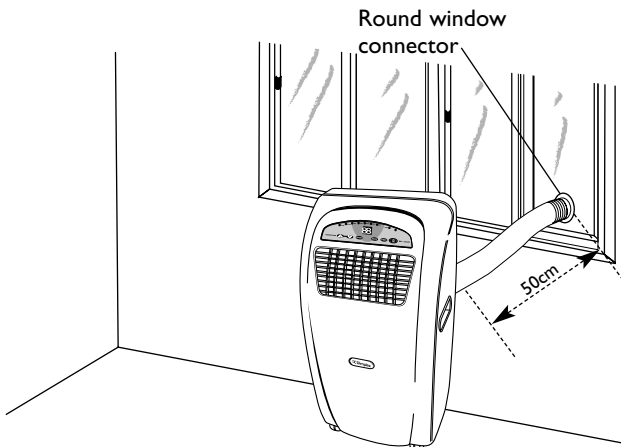

## Mounting of the exhaust pipe

1. The supplied exhaust hose can be extended from 300 to 1500mm for mounting. It is recommended that you use the hose in the shortest possible length.

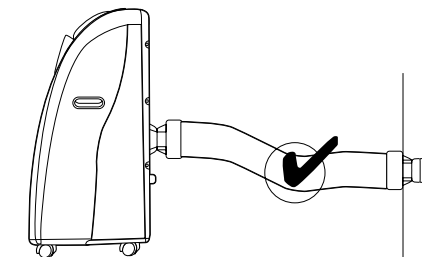

2. Take care to prevent any bow or bend in the middle of the exhaust hose, as this will trap hot exhaust air, which will radiate into the room and cause this unit to shut itself off due to overheating.

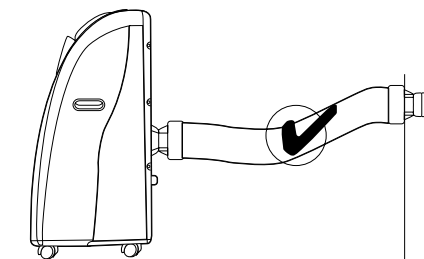

## WARNING!

*The length of the exhaust pipe is specially designed according to the specification of this product. Do not replace or extend it with your own private hose as this could cause the unit to malfunction and*

**VOIDS WARRANTY**

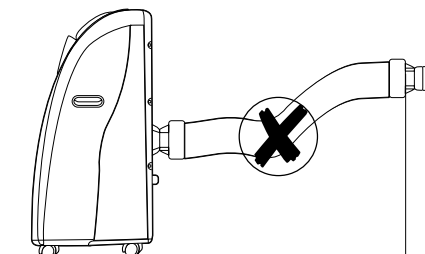

---

---

## Operation.

---

1. Comfort Level setting indicator.
2. Room Level /Temperature Indicator.
3. Lo Fan Indicator.
4. High Fan Indicator.
5. Automatic Mode Indicator.
6. Cooling Mode Indicator.
7. Fan Mode Indicator.
8. Timer Indicator.
9. Compressor On Indicator / Water tank full indicator, blinks when tank requires emptying.
10. Comfort / Temperature Level UP Button.
11. Comfort/ Temperature Level Down Button.
12. Fan Speed Button.
13. Mode Option Button.
14. Timer Button.
15. ON/OFF Button.

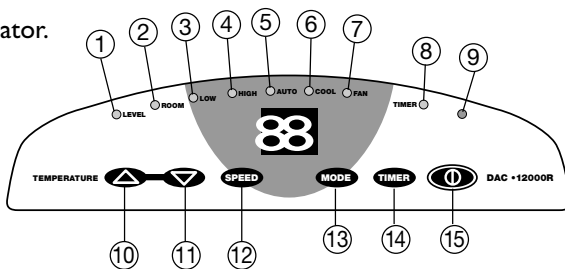

### Turning ON/OFF.

Press ON/OFF button, the unit will start automatically. If the ambient temperature is

- Higher than 23°C, the unit will start in cooling mode.
- Below or equal to 23°C, the unit will start in fan/ventilation mode.

Indicator lights up indicating what functions have been activated.

The display window shows the ambient room temperature.

To turn the unit off press ON/OFF button again.

### Setting Mode/Function.

Press MODE button to select required mode, automatic, cooling or fan.

The indicator of your selected mode will illuminate.

### Setting the Temperature/ Comfort Level.

Press “Temperature up’ or ‘Temperature down’ button to regulate the comfort you desire.

The display window will indicate the Comfort you set as you press ‘Temperature up’ or ‘Temperature down’ button.

The indicator will always revert back to show the ambient room temperature.

The preset Comfort level of the machine is level 24. The comfort level setting ranges from 16 to 30.



## Setting the Fan Speed.

1. Press SPEED button to choose the speed you require, low or high. The indicator of high or low will illuminate to show your selection.
2. If the unit is in Auto mode, the fan speed is automatically set according to the ambient temperature (the related indicators will illuminate) the speed button is invalid.

## Setting the Auto Off Timer.

Press TIMER button to set the operating hours you desire (1 to 12 hours, the timer indicator will illuminate). When the set time has been reached, the machine will turn off automatically. The display window will show the hour(s) you set as you press the TIMER button.

If the timer button is not pressed, the unit will work continuously.

## Setting the Pre-Set Timer.

When the machine is switched off, the pre-set timer can be used to turn the machine on, between 1 and 12 hours later. Press the timer button only, the display window will show 1 indicating the machine will start operating in 1 hour. Each press increases the time by 1 hour.

**All of the above functions can also be performed with the supplied remote control. This remote control requires 2 x AAA batteries to operate.**

## Regulating air flow direction

Turn the roller on air vent to control the air flow direction of the vertical louvres.

Move the air vent directly to adjust the air flow direction of the horizontal louvres.

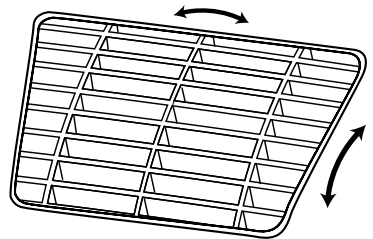
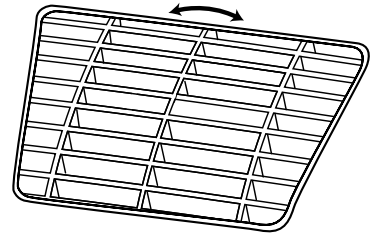

## NOTICE!

*To prolong the compressor's life, the compressor will only work 3 minutes after you switch the unit on or re-switch on. The cooling system will switch off if the ambient temperature is lower than the set comfort level. The ventilation, however, keeps working on the set level. If the ambient temperature rises above the selected level, the cooling will start working again.*

---

## Drainage.

---

During the process of cooling, water is extracted from the air and collected in the water tank inside the unit. When the tank is full the compressor will stop and the 'Compressor On Indicator' (Indicator 9 on control Panel) will blink to remind you to empty the water tank. During this time the fan will continue to operate, circulating the air. The water tank should be emptied as follows.

1. Turn off the unit.
2. Position the supplied plastic water tray, flat on the floor, under the drain hole.
3. Remove the water stopper and the rubber plug. Empty the condensed water from the air conditioner.
4. When the water tray is almost full, replace the rubber plug to stop the flow of water, empty the water tray.
5. Repeat step 2, 3, 4, till all the condensed water is emptied.
6. After all condensed water is drained, replace the rubber plug and water stopper.

The Compressor indicator should stop blinking.

1. *All condensed water must be drained prior to relocation or storage.*

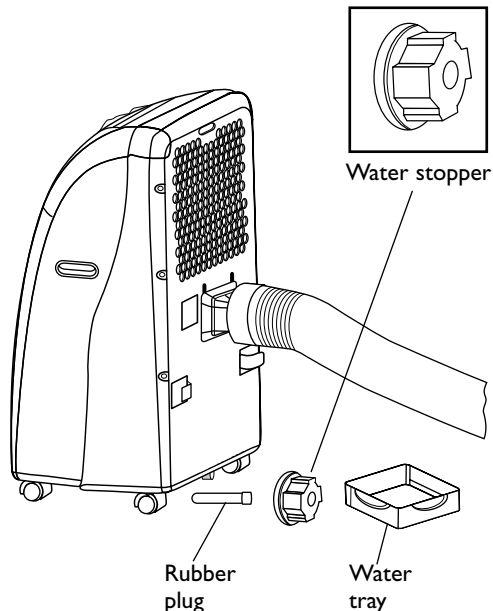

## Dehumidification.

**NOTE!** *The machine operates in the cooling mode but it does not lower the room temperature. It absorbs the excessive humidity present in the air.*

1. Plug the unit into proper electrical outlet.
2. Position the exhaust tube as shown or remove from the air-conditioner.
3. Set the **FAN SPEED** control to the desired output of airflow, high or low.
4. Set the **COMFORT LEVEL TO** the maximum cooling position.
5. When the water tank is full, the compressor on indicator will blink and the compressor will shut off automatically, the fan will stay on circulating the air. At this time, you must empty the water tank as described "Draining the Condensed Water".

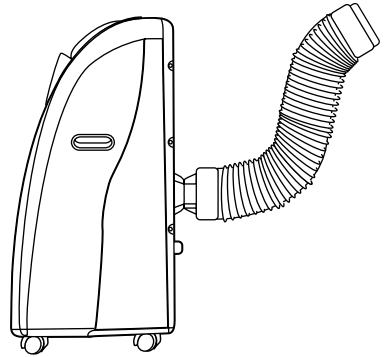

## Continuous Drainage.

In very humid conditions to avoid the unit from continually shutting down when the water tank is full the unit can also be continuously drained if a convenient drainage position is available.

### Important!

*The water is only gravity drained therefore the tube must lay lower and drain at a lower level than the outlet tube at the rear of the air conditioner.*

- Before operating the air conditioner, remove the water stopper, take out the rubber plug and connect a PVC tube 12mm diameter.

---

---

## Maintenance.

---

**Always unplug the unit from the mains before beginning the cleaning.**

### Cleaning the housing

- Use a soft, damp cloth to wipe the body clean.
- Never use aggressive chemicals, gasoline, detergents, chemically treated cloths, or other cleansing solutions. These all could possibly damage the cabinet.

### Cleaning the filter

- Use a vacuum cleaner or tap the filter lightly to remove loose dust and dirt from the filters and then rinse thoroughly under running water (no hotter than 40°C).
- Dry thoroughly before replacing.

**NOTICE!** Never operate the unit without the filters.

## End of season storage

- Unplug the unit.
- Drain the condensed water COMPLETELY (Please refer to drainage clause).
- Clean or change the filter.
- Turn on the unit in ventilation mode for a couple of hours, so the inside can dry out completely.
- It is recommended that the unit be put back into the original carton for storage and do not stack heavy objects on top of the unit.

## Power cord storage

- When the unit is not in use, please store the power cord as per illustration opposite.

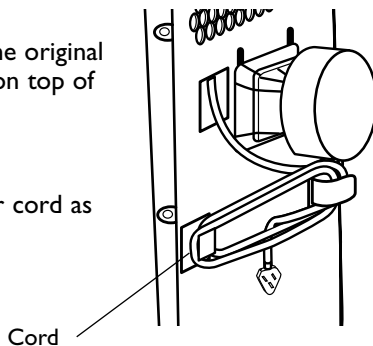

---

---

## Trouble Shooting Guide.

---

If the product is treated in the right manner, you should encounter no problems. In case of difficulties, please check the following points before calling for the maintenance service.

Product does not work	• Check whether the product is plugged in.
No cool air	• Has three minutes passed after switching on the unit, check whether the water tray is filled. • The room temperature should be in the operating range of 16°C-30°C. • Is the set temp higher than the room temp.
Weak ventilation performance	• Check if the exhaust hose is blocked or kinked. • Check if the filter is dusty.
The unit is noisy	• Check that the unit is sitting on a level surface.

*After long usage, the product should be cleaned by a professional maintenance service centre.*